

HBA

Forked tubular axial fans with motor outside the air flow.



Forked tubular fans for moving air of up to 150°C continuously and up to 200°C sporadically

Fan:

- Sheet steel tubular casing
- Impeller made from cast aluminium
- Airflow direction from impeller to motor

Motor:

- Motors with IE-2 efficiency. Except for motors with lower powers than 0.75 kW. single-phase motors or two-speed motors.
- Class F motors with ball bearings. IP-55 protection
- Three-phase 230/400V.-50Hz. (up to 5.5HP.) and 400/690V.-50Hz. (power over 5.5HP.)
- Working temperature: -25°C.+ 150°C.

Finish:

- Anticorrosive with heat-protection paint for working in hot environments.

On request:

- Casing made from stainless steel
- Hot galvanised finish
- Special windings for different voltages and motors with PTC

Model	Speed	Max. Motor current		Power	Max. Airflow	Sound Pressure level	Weight
	r/min.	Amp. 230 V.	Amp. 400 V.	kW.	M³/h	dB(A)	Kg.
HBA 31 2T	2760	2,57	1,49	0,55	2900	77	25
HBA 31 2M	2810	3,49	-	0,55	2900	77	26
HBA 31 4T	1350	1,66	0,96	0,25	1600	66	24
HBA 31 4M	1370	2,00	-	0,25	1600	66	25
HBA 40 2T	2860	4,20	2,40	1,10	6200	82	45
HBA 40 2M	2820	6,51	-	1,10	6200	82	46
HBA 40 4T	1370	2,02	1,17	0,37	3200	75	40
HBA 45 2T	2900	10,18	5,88	3,00	8550	84	57
HBA 50 4T	1410	3,10	1,79	0,75	6750	76	73
HBA 63 4T	1400	4,03	2,32	1,10	11150	77	91
HBA 71 4T	1440	14,10	8,12	4,00	15850	79	164
HBA 71 6T	900	2,99	1,73	0,55	11200	74	140
HBA 80 6T	945	4,88	2,82	1,10	14900	77	190
HBA 100 6T	945	4,88	2,82	1,10	21700	80	260

Accessories:



INT



AR



VSD



RT



BTUB



BAC



PS



S

bosa ventilatoren bv

Pobox 73 – 3890 AB, Gaffel 24 – 3891 KD Zeewolde – Holland
 Tel. 0031-36522 22 23, Fax 0031-36522 22 26
 website: www.bosa.nl email: info@bosa.nl

HBA 31....50

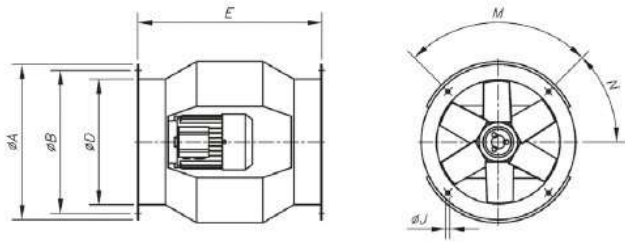

HBA 63.....100

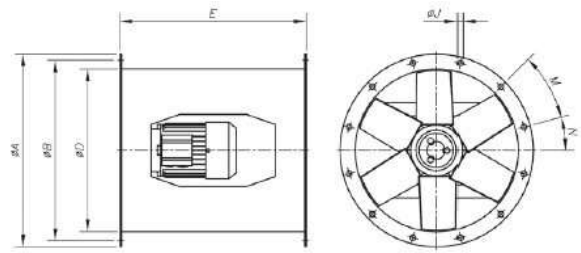

Model	ØA	ØB	ØD	E	ØJ	M	N
HBA 31	385	355	308	460	10	4x90°	45°
HBA 40	490	450	410	580	12	8x45°	22,5°
HBA 45	540	500	460	640	12	8x45°	22,5°
HBA 50	600	560	514	730	12	12x30°	15°
HBA 63	730	690	640	730	12	12x30°	15°
HBA 71	810	770	710	770	12	16x22,5°	11,25°
HBA 80	900	860	800	830	12	16x22,5°	11,25°
HBA 100	1115	1070	1000	1270	15	16x22,5°	11,25°

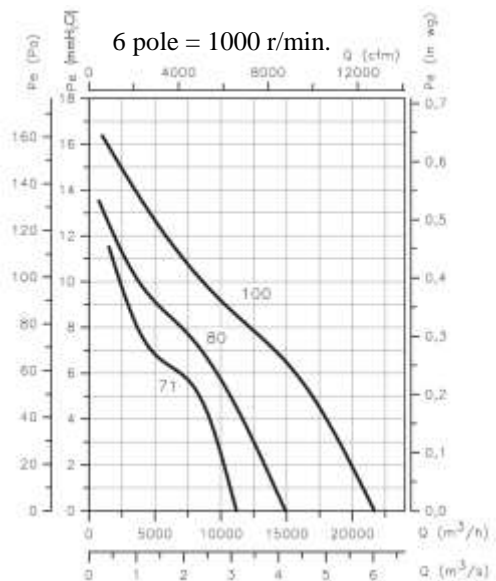
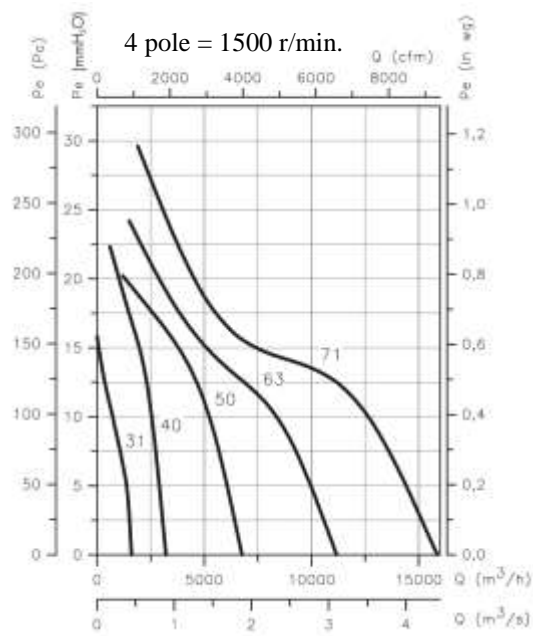
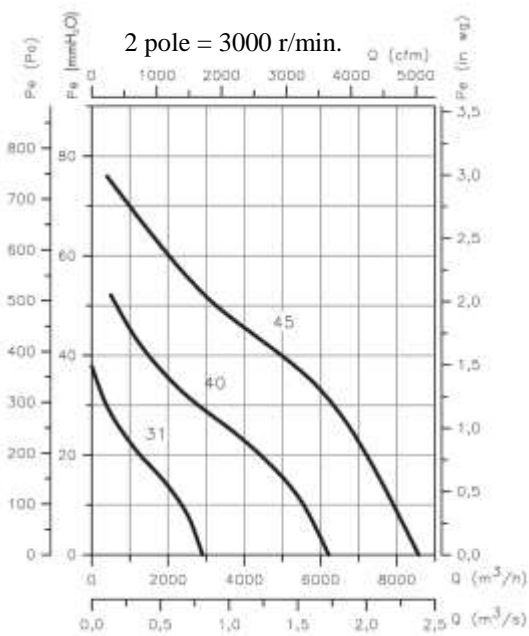

bosa ventilatoren bv

Pobox 73 – 3890 AB, Gaffel 24 – 3891 KD Zeewolde – Holland
 Tel. 0031-36522 22 23, Fax 0031-36522 22 26
 website: www.bosa.nl email: info@bosa.nl

INT



Stop-start safety switches in accordance with Standard UNE-EN 60204-1.

Features:

- Switches to install beside the fan, so that the mains current can be cut off before handling the fan.
- IP65 protection
- For single-phase or three-phase fans, use a 3-pole switch (3CA).
- For three-phase two-speed fans, use 6-pole switch (6CA).

AR



Soft starters for three-phase motors.

Features:

- Especially designed to reduce the current peak caused during start-up of fans with three-phase motors.
- Supplied voltage 400V + - 10% 50/60Hz
- Mounted in box for DIN-35 rail
- Possibility of adjusting the starting torque, acceleration time and deceleration time.

VSD



Variable speed drive for AC motors.

Features:

- Converter for varying the speed, via voltage and frequency, of axial and centrifugal fans with asynchronous three-phase motors
- Converter supply:
 - Single-phase (VSD1/B): 200-240V 50/60 Hz
 - Three-phase (VSD3/B): 380-480V 50/60 Hz
- In accordance with Electromagnetic Compatibility Directives 92/31/EEC and 93/68/EEC and in accordance with Low Voltage Directive 73/23/EEC
- On/Off input to enable/disable the variable speed drive.
- 0-10V input for speed control.
- Connection available to ModBus RTU bus.

bosa ventilatoren bv

Pobox 73 – 3890 AB, Gaffel 24 – 3891 KD Zeewolde – Holland
Tel. 0031-36522 22 23, Fax 0031-36522 22 26
website: www.bosa.nl email: info@bosa.nl

RT

Protection guard for inlet or outlet of long-cased axial fans.

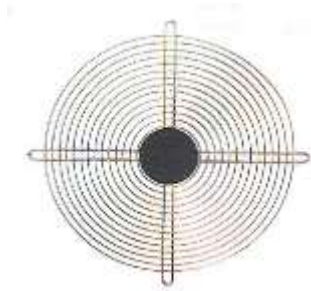

Model	For fan type					
	HEPT	HCT	HGT	HPX	THT	HBA
RT-25	-	25	-	-	-	-
RT-31/B	-	31	-	-	-	-
RT-31	31	-	-	-	-	31
RT-35	35	35	-	35	-	-
RT-40	40	40	-	-	40	40
RT-45	45	45	-	45	45	45
RT-50	50	50	-	50	50	50
RT-56	56	56	-	56	56	-
RT-63	63	63	-	63	63	63
RT-71	-	71	-	71	71	71
RT-80	-	80	-	80	80	80
RT-90	-	90	-	90	90	-
RT-100	-	100	-	100	100	100
RT-125	-	-	125	-	125	-
RT-125/CC	-	-	125	-	125	-

BTUB

Coupling flange for axial fans.



Model	Dimensions In mm.			For fan type						
	ØC	ØA	F	HEPT	HCT	HGT	THT	HPX	HT	HBA
BTUB-250	250	310	80	-	25	-	-	-	25	-
BTUB-280	280	350	80	-	31	-	-	-	-	-
BTUB-315	315	380	80	31	-	-	-	-	31	31
BTUB-355	355	430	80	35	35	-	-	35	35	-
BTUB-400	400	480	80	40	40	-	40	-	40	40
BTUB-450	450	530	80	45	45	-	45	45	45	45
BTUB-500	500	590	80	50	50	-	50	50	50	50
BTUB-560	560	650	80	56	56	-	56	56	56	-
BTUB-630	630	720	80	63	63	-	63	63	63	63
BTUB-710	710	800	80	-	71	-	71	71	71	71
BTUB-800	800	890	100	-	80	-	80	80	80	80
BTUB-900	900	1000	100	-	90	-	90	90	90	-
BTUB-1000	1000	1100	100	-	100	-	100	100	100	100
BTUB-1250	1250	1365	100	-	-	125	125	-	-	-

bosa ventilatoren bv

Pobox 73 – 3890 AB, Gaffel 24 – 3891 KD Zeewolde – Holland
 Tel. 0031-36522 22 23, Fax 0031-36522 22 26
 website: www.bosa.nl email: info@bosa.nl

BAC

Double, elastic coupling flange for axial fans



Model	Dimensions in mm.			For fan type							
	ØD	ØA	H	HEPT	HCT	HGT	CHT	HT	HPX	HBA	CHRE
BAC-160	160	220	340	-	-	-	-	-	-	-	722
BAC-180	180	240	340	-	-	-	-	-	-	-	825
BAC-250	250	310	340	-	25	-	200/225	25	-	-	1131
BAC-315/B	280	350	340	-	31	-	-	-	-	-	-
BAC-315	315	390	340	31	-	-	-	31	-	31	-
BAC-355	355	430	340	35	35	-	250/315	35	35	-	1135/ 1240
BAC-400	400	480	340	40	40	-	-	40	-	40	-
BAC-450	450	530	340	45	45	-	-	45	45	45	-
BAC-500	500	590	340	50	50	-	400/450	50	50	50	1445/ 1650
BAC-560	560	650	340	56	56	-	-	56	56	-	-
BAC-630	630	720	340	63	63	-	500	63	63	63	-
BAC-710	710	800	340	-	71	-	560/630	71	71	71	-
BAC-800	800	900	340	-	80	-	-	80	80	80	-
BAC-900	900	1000	340	-	90	-	-	90	90	-	-
BAC-1000	1000	1100	340	-	100	-	-	100	100	100	-
BAC-1250	1250	1365	340	-	-	125	-	-	-	-	-

PS



Support stands for long-cased fans.

S



Silencers to fit to inlet or outlet.

bosa ventilatoren bv

Pobox 73 – 3890 AB, Gaffel 24 – 3891 KD Zeewolde – Holland
 Tel. 0031-36522 22 23, Fax 0031-36522 22 26
 website: www.bosa.nl email: info@bosa.nl